

THREADING THE MACHINE:



Turn off main power switch before threading! When using clutch motors without actuation lock wait until the motor has completely stopped.

Thread the machine according to the following threading illustrations.

NOTE: When threading two needle machines use needles "A" & "C".

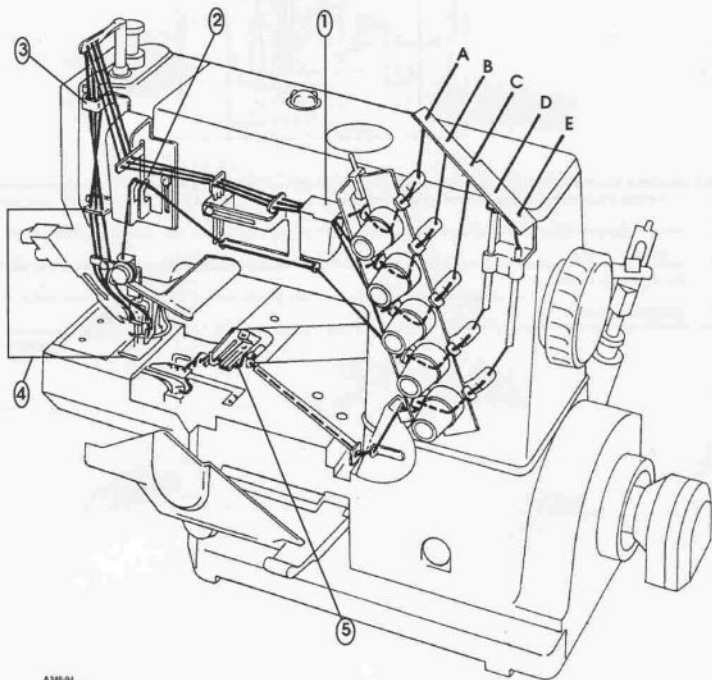

A348-04

- A Left Needle Thread
- B Middle Needle Thread
- C Right Needle Thread
- D Spreader Thread
- E Looper Thread

- ① Thread Lubricator Area
- ② Needle Thread Eyelet Area
- ③ Needle Bar Area
- ④ Thread Nipper, Spreader Area
- ⑤ Thread Take-Up Area

NOTE: When threading two needle machines use needles "A" & "C". DO NOT use needle "B".

From the library of: Superior Sewing Machine & Supply LLC